

LIGHTWAVE 38' PC

Remarkably Roomy, Exceptionally Efficient



Take me there

This superbly designed powercat delivers a level trim and the high speed displacement hulls return excellent fuel efficiency at realistic cruising speeds. With a range of 750 nm before your next fuel stop, the Lightwave 38 Powercat will take you to that perfect remote destination in supreme comfort.



www.lightwaveyachts.com

LIGHTWAVE 38' PC



The Lightwave 38' Power Catamaran is luxuriously appointed. The standard accommodation includes two queen size staterooms and a third double cabin. A large bi-fold sliding saloon door offers a seamless flow to the cockpit and saloon areas and the optional Galley Up layout makes this an entertainers masterpiece. A full forward ensuite with separate shower and toilet is available in the layout options. The extended aft cabin option features a viewing window in the hull and offers an island style queen bed. An end mounting queen size bed is also available in the port forward cabin. The optional flybridge, adds a dominant edge to the sleek lines of the vessel. It has access via internal steps on the port side of the cockpit, providing safe and secure entry. Featuring a forward facing console on the starboard side with twin seat, and perimeter seating, this area offers an impressive extension to the entertainment area and a bird's eye view for the skipper.

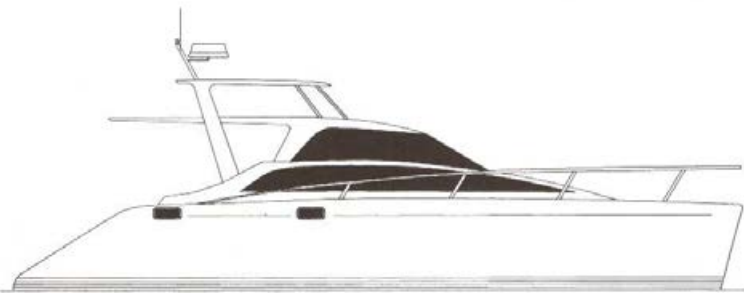

TECHNICAL SPECIFICATIONS

Length Overall	11.3 m	38'0"
Beam – Maximum	6.67 m	21'9"
Head Room (Saloon)	1.90 m	6'2"
(Hulls)	1.95 m	6'4"
Bridge Clearance (D.W.L)	0.70 m	2'4"
Keel Draft	1.15 m	3'9"
Displacement – Light Ship	6000 kg	13 228 lb
Max. Disp. (D.W.L)	7000 kg	15 432 lb
Fuel Capacity – normal capacity	500 lt	110 GB gal. 132 US gal.
Fresh Water Capacity	500 lt	110 GB gal. 132 US gal.
Additional Tankage (Optional)	250 lt	55 GB gal. 66 US gal.

ENGINES

Diesel Engines Propulsion	2 x 39 hp Yanmar or Volvo Penta Engines Twin 3 blade fixed propellers on sail drive legs
Maximum Speed	9.5 knots
Fuel Consumption	4 lt per hour per engine @ 12.2 knots 3.7 lt per hour per engine @ 8 knots
Range	750 nm (with 750 lt fuel)

ACCOMMODATION

Standard 3 cabin layout	6-8 persons (Subject to layout)
Many layouts available. Individually customised.	

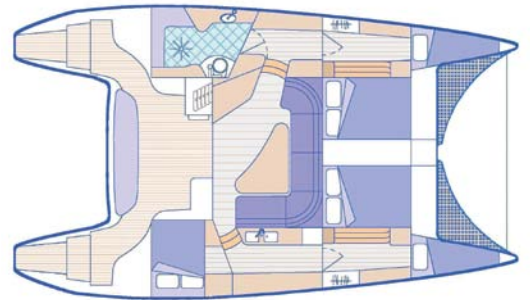

Standard Layout

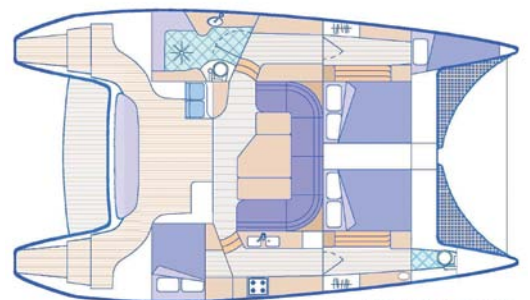

Family Layout with Duckboard

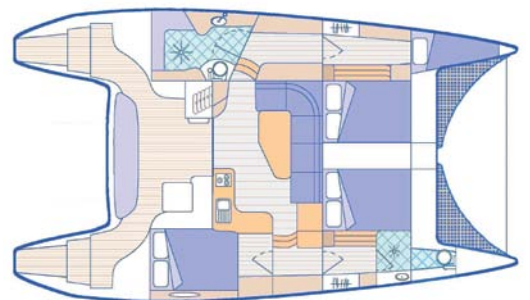

Charter Layout, Galley Up with Extended Aft Cabin



(A) All figures are provisional and subject to change. (B) Right is reserved to make changes, modifications or improve production without prior notice.
(C) Weight shown is estimate of model's weight displacement with average optional equipment aboard at time of delivery.
(D) Capacities of tanks are estimated to be total capacity of tanks. Usable capacities will vary depending upon conditions.

Take me there Take me there Take me there